

# RYHOPE / TUNSTALL PERIPHERY DEVELOPMENT AREA

Fig 1.1 UDP Proposals

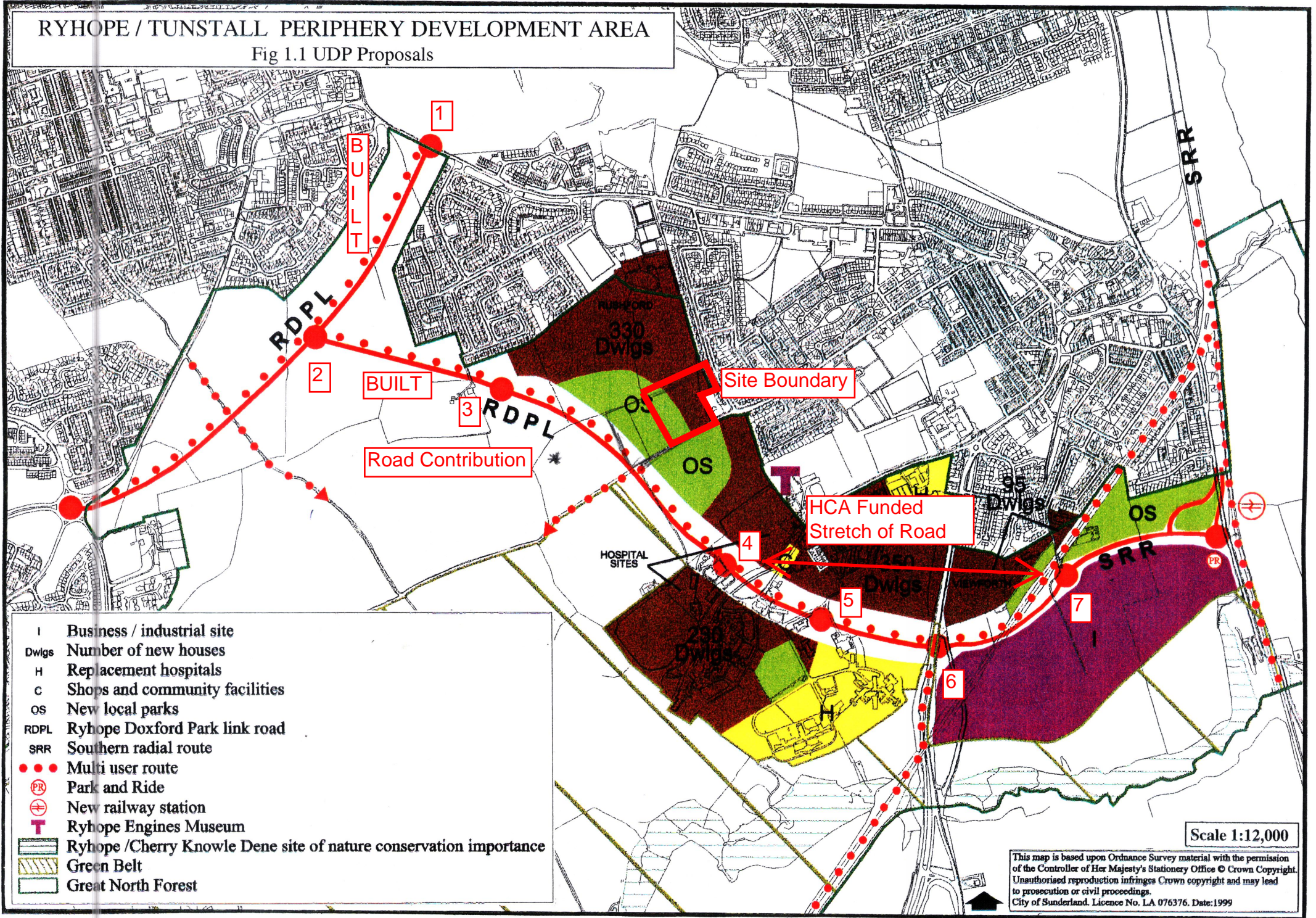

- I Business / industrial site
- Dwgs Number of new houses
- H Replacement hospitals
- C Shops and community facilities
- OS New local parks
- RDPL Ryhope Doxford Park link road
- SRR Southern radial route
- Multi user route
- Ⓟ Park and Ride
- ⊕ New railway station
- T Ryhope Engines Museum
- ▨ Ryhope /Cherry Knowle Dene site of nature conservation importance
- ▨ Green Belt
- ▨ Great North Forest

Scale 1:12,000

This map is based upon Ordnance Survey material with the permission of the Controller of Her Majesty's Stationery Office © Crown Copyright. Unauthorised reproduction infringes Crown copyright and may lead to prosecution or civil proceedings. City of Sunderland. Licence No. LA 076376. Date: 1999