



This map is based upon the Ordnance Survey material with the permission of the Ordnance Survey on behalf of the Controller of Her Majesty's Stationery Office © Crown copyright. Unauthorised reproduction infringes Crown copyright and may lead to prosecution or civil proceedings. Licence No. 100018385, Date 2006.

KEY

-  Proposed: No Waiting At Any Time
-  Proposed: No Waiting Between 9:00am & 10:00am and 2:00pm & 3:00pm
-  Proposed: No Waiting Between 10:00am & 11:00am and 3:00pm & 4:00pm
-  Proposed: 30 Minutes No Return Within 4 Hours
-  Proposed: Bus Stop Cleanway

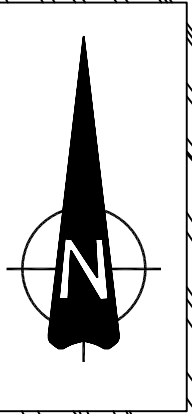
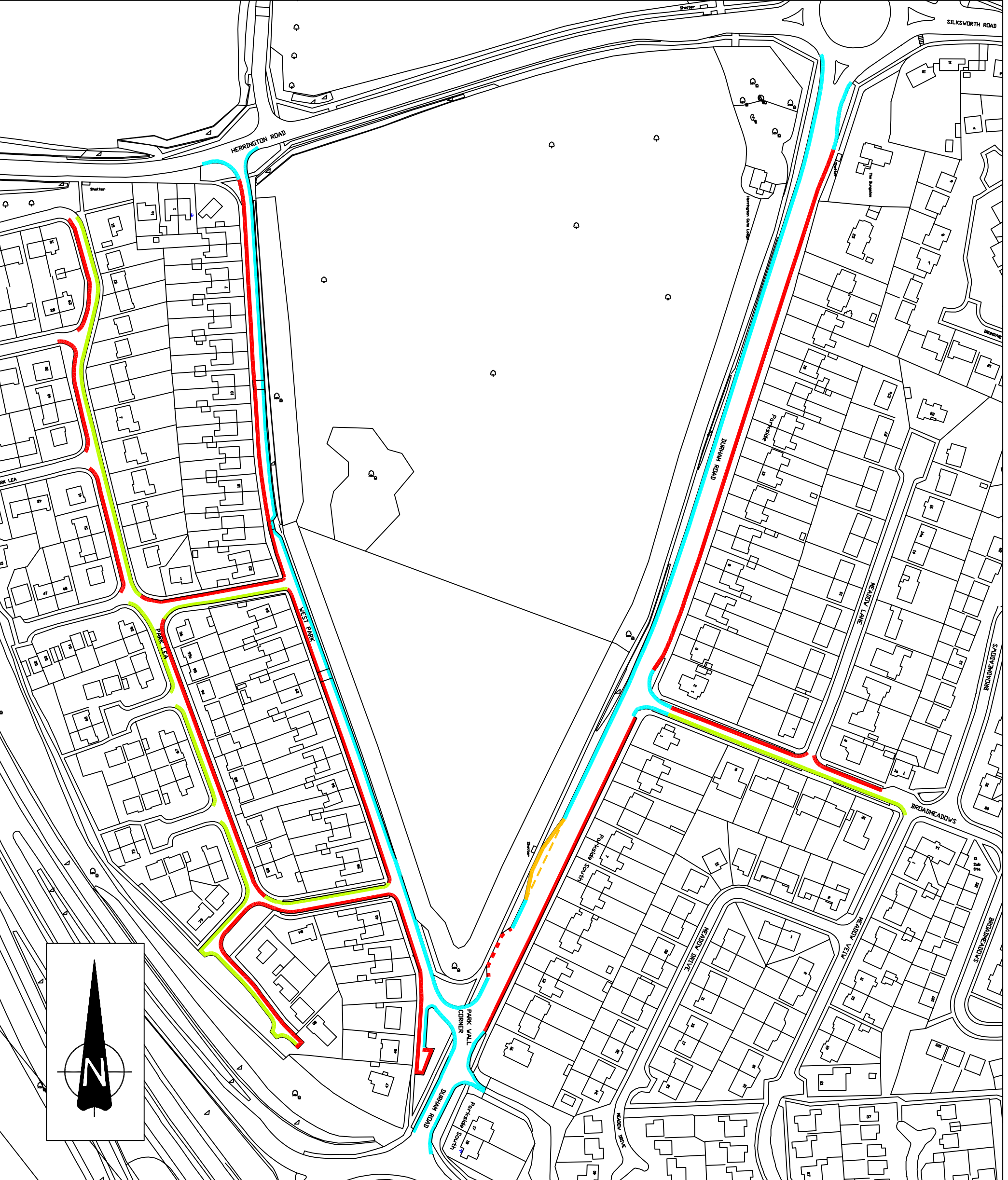

Rev	Description	Date	Date	Date
		revised	checked	checked



Development and Regeneration Services
P.O. Box 102, Civic Centre
Sunderland SR2 7DN

Telephone: 0191 520 5555
Fax: 0191 553 1460
Web: www.sunderland.gov.uk

PROJECT
West Park, Park Lea,
Durham Road (A690) & Broadmeadows

TITLE
Proposed Waiting Restrictions

PROJECT CONTACT
R Bertram

CONTACT DETAILS
0191 5611523

DRAWN DK **APPROVED** R Bertram

DATE Sept 2007 **SIGNED**

CHECKED BY BB **DATE**

DATE Nov 2007 **SHEET SIZE** A3

SCALE NTS **DRAWING NO.** 09 / TM / 1269 / 01 **REVISION** B